

Load Class
up to C250
EN-1433 Standard

EUROSELFV+

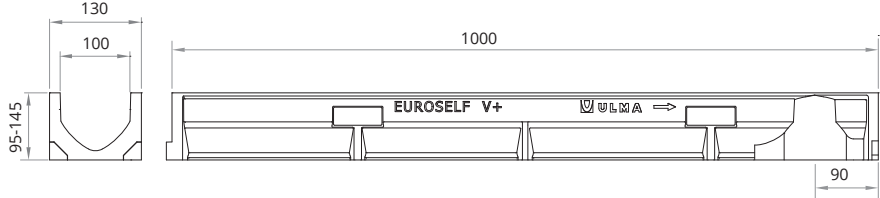

ULMA Linear Drainage Channel, type EUROSELFV+; External width 130 mm, Internal width 100 mm; Available with overall heights between 95 mm and 145 mm, to collect rainwater in 1 meter long units, optimized V-shape with self-cleaning effect; especially designed for channel runs with no longitudinal slope. Locking system consist of locking bar and screws.



CHANNELS

Code Channel	L mm	H mm	Width mm		Ø Outlet* mm		Hydraul. Section cm ²	Pcs. pallet	Weight Kg	Qref l/s
			Ext.	Int.	Vert.	Hor.				
EUROSELFV+ H95	1000	95	130	100	110	-	66	120	7,3	2,0
EUROSELFV+ H125	1000	125	130	100	110	-	95	105	8,7	3,5
EUROSELFV+ H145	1000	145	130	100	110	-	114	90	9,7	4,7

* Vertical outlets on order

GRATINGS

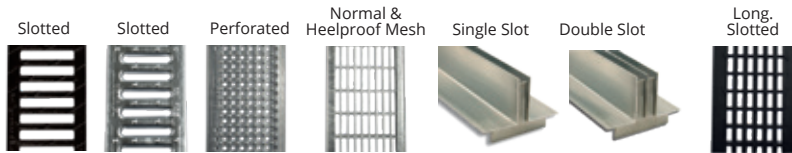

Material	Design	Load	Code	L mm	Width mm	Thickness mm	Opening mm	Weight Kg	Intake area cm ² /ml
DUCTILE IRON	SLOTTED	B125	FNX100UCBM	500	130	6	14,9	2,1	530
	SLOTTED	C250	FNX100UCCM	500	130	6	13	2,7	435
GALVANISED STEEL	SLOTTED	A15	GN100UCA	1000	130	3	9	1,6	268
	PERFORATED	A15	GP100UCA	1000	130	3	Ø6	1,4	159
	MESH*	B125	GEX100UCB33	1000	130	2	30 x 30	3,2	837
	HEELPROOF MESH*	B125	GEHX100UCB	1000	130	2	30 x 10	3,9	749
	SLOT*	C250	GR100UOC	1000	130	70	15	4,8	150
	DOUBLE SLOT*	C250	GDR100UOC	1000	130	70	2 x 12	5,5	240
STAINLESS STEEL	SLOTTED	A15	IN100UCA	1000	130	3	7	1,5	218
	PERFORATED	A15	IP100UCA	1000	130	3	Ø6	1,7	651
COMPOSITE	LONG. SLOTTED BLACK	A15	PNLH100UCAM	500	130	3	8	0,3	367
	LONG. SLOTTED GREY	A15	PNLH100UCAM GRIS	500	130	3	8	0,3	367

* Available in stainless steel, consult design

HOW TO FIX

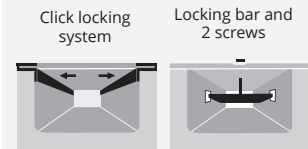

Code	Units ml
TEF840 + CS100	2 + 2
TEF840 + CS100	2 + 2
(1) TNPC850 + CS100	2 + 2
TNPC850 + CS100	2 + 2
TEF840 + CS100	2 + 2
TEF840 + CS100	2 + 2
(2)	(2)
(2)	(2)
TXNPC850 + CS100INOX	2 + 2
TXNPC850 + CS100INOX	2 + 2
(1) TXE840 + CS100INOX	2 + 2
(1) TXE840 + CS100INOX	2 + 2

(1) Click. Without screws.
(2) Supported

SUMP UNITS

Code	L mm	H mm	Width mm	Lateral outlets Ø mm	Front outlet Ø mm	Sump units	Weight Kg
AEURO100	500	300	130	90/110	90	1	14,4

BUCKET

Code
CEURO100

OPEN END CAP

Code	Ø mm
TEURO100VH95A	90
TEURO100VH125A	90
TEURO100VH145A	110

CLOSED END CAP

Code
TEURO100VH95C
TEURO100VH125C
TEURO100VH145C